

## INNO- PROOF FOX SWELLING TAPE 520 Hydrophilic Volcanized Expanding Rubber Band

### Description

**FOX SWELLING TAPE 520**, is a flexible waterstop tape based on chloroprene rubber and hydrophilic resin that swells when in contact with water.

### Usage Areas

- In the joints of ready-mixed concrete elements,
- In construction joints in reinforced concrete structures poured in place (cold joints where the curtains meet the foundations, etc.),
- As a watertight flange at the inlets and outlets of pipes passing through reinforced concrete,
- In tunnel segments,
- In the joints between the slab and the pile foundation caps,
- It is used in concrete and steel joints.

### Advantages

- Easy to apply.
- It is economical.
- Expansion continues up to 500% in contact with water.
- It has a protective coating that prevents premature expansion. **FOX SWELLING TAPE 520** starts swelling later than standard inflating tapes. Under normal conditions, the onset of swelling is 7 days after contact with water. This prevents the product from swell in the construction site environment when it encounters undesired water (such as rain). In addition, at the first contact with the fresh concrete, the concrete will swell before it starts to set due to the effect of the concrete water, thus preventing the formation of an unwanted gap between the concrete and the swelling band.
- It is flexible, can be applied to irregular substrates.
- It expands in contact with water in reinforced concrete, including concrete elements, and forms a leak-proof seal.
- It has the property of expanding when it comes into contact with water again.
- Wide range of resistance against chemicals.
- Resistant to petroleum products, minerals, vegetable oils and greases.
- **FOX SWELLING TAPE 520** is impact resistant.
- It is suitable to be used in polluted / slurry waters in areas where the water level rises and falls.

### Technical Data

Density	1,22 kg/dm <sup>3</sup>
Color	Blue
Expansion Rate	%500
Swelling Pressure	1,30 N/mm <sup>2</sup>
Water-Repellent	2 bar
Toxic Content	None
Dimensions	5 x 20 mm

The above values are given at +23°C and 50% relative humidity. High temperatures shorten the time, low temperatures lengthen the time.



## Application Procedure Surface Preparation

**FOX SWELLING TAPE 520** The surfaces to be applied must be free of dust, dirt, oil and loose particles (**Figure 1**).

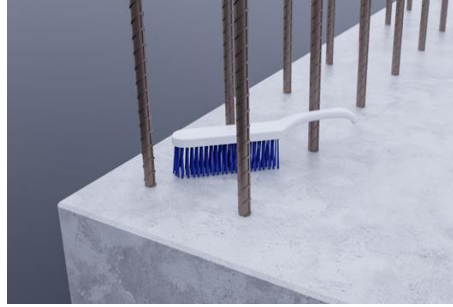

**Figure 1**

## Application

The **FOX SWELLING TAPE 520** only works in cramped and tight spaces. Since the expansion of **FOX SWELLING TAPE 520** produces a certain pressure, it is recommended to place it in the middle of the joint. It should be fixed on smooth surfaces with 20-30 cm intervals between inner and outer reinforcement with mechanical fixation or **FOX PURSEAL PS600** mastic (Figure 2-3). On rough surfaces; Balancing is done with (+,-) 3 cm wide **FOX PURSEAL PS600** mastic. **FOX SWELLING TAPE 520** profiles are pressed well into the mastic. In addition to the mastic, mechanical fixation should be done at 20-30 cm intervals. **FOX SWELLING TAPE 520** can be applied around pipes, in concrete pipe transitions. **FOX SWELLING TAPE 520** must be attached with **FOX PURSEAL PS600** mastic or tie wire. If it is placed in rainy weather or while in contact with water for a long time, these situations should be avoided as pre-swelling will occur in the profiles.



**Figure 2**



**Figure 3**

## Important Note

In order to ensure full sealing, all of the profiles must be in contact with the joint surface. The ends should be placed in such a way that they complement each other without overlapping.



**Figure 4**

## Coverage

Quantity is needed as much as the joint length to be applied.

## Package

50 mt/box (in 5 x 10 m rolls)



## Storage

It should be stored in its unopened original package, in a cool and dry environment, protected from frost. In short-term storage, maximum 2 pallets should be placed on top of each other and the shipment should be made on a first-in, first-out basis. In long-term storage, pallets should not be placed on top of each other.

## Safety Precautions

It is dangerous to approach storage and application areas with fire. Storage and application areas should be ventilated. During the application, work clothes, protective gloves, glasses and masks in accordance with the occupational and worker health rules should be used. During storage and application, it should not be contacted with the skin and eyes, in case of contact, it should be washed with plenty of soap and water. If swallowed, a doctor should be consulted immediately. Food and beverage materials should not be brought into the application areas. It should be stored out of the reach of children. For detailed information, the Material Safety Data Sheet should be consulted.

## Disclaimer

The data contained in this technical document is based on our scientific and practical knowledge. SARTECH Yapı Malzemeleri San. ve Tic. Ltd. Sti. only responsible for the quality of the product. SARTECH Yapı Malzemeleri San. ve Tic. Ltd. Sti. cannot be held responsible. The responsibility for the correct application of our product belongs to the user. Our company is only responsible for the quality of the product. This catalog overrides the information in the previous catalogue. Our company reserves the right to make changes in any information and content details in this catalogue. It is essential to check that the information in the catalog is up-to-date and valid. All rights reserved.

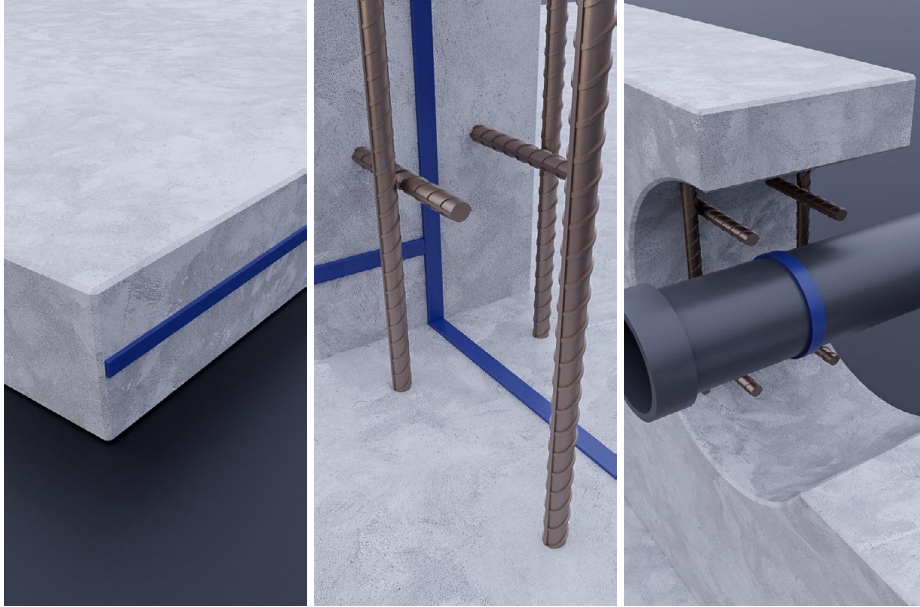

**Figure 5: Application Areas**

